

# TTW4

## Light Duty Commercial Power Vent Energy Saver Gas Water Heaters



Photo is of  
TW4-65S-70FB-3N

*The TTW<sup>®</sup>4 FVIR Defender Safety System<sup>®</sup> Models Feature (50 and 65 gallon models, only):*

- **Advanced ScreenLok<sup>®</sup> Technology Flame Arrestor Design**—Flame arrestor is designed to prevent ignition of flammable vapor outside of the water heater
- **Flammable Vapor Sensor**—Electronic sensor prevents burner operation if flammable vapors are detected. The sensor will also prevent operation if there is ongoing flammable vapor burn inside the combustion chamber.
- **Maintenance Free**—No regular cleaning of air inlet openings or flame arrestor is required under normal conditions.
- **Sight Window**—Offers a view into the combustion chamber to observe the operation of the pilot and burner.
- **Pedestal Base**—Rugged and durable base allows easy transport and positioning, and provides corrosion resistant contact with floor.

*All TTW<sup>®</sup>4 Models Feature:*

- **Factory Installed Hydrojet<sup>®</sup> 2<sup>™</sup> Total Performance System**—Cold water inlet sediment reducing device helps prevent sediment build up in tank. Increases first hour delivery of hot water while minimizing temperature build up at top of tank. (TW4-75S has Factory Installed Hydrojet<sup>®</sup>).
- **Vitraglas<sup>®</sup> Lining**—Bradford White water heater tanks are protected from the corrosive effects of hot water by a ceramic porcelain-like coating. The exclusive high silica ceramic lining provides a tough interior surface for our water heater tank.
- **Powerful Blower Motor**—Our design has higher torque for greater resistance to outside winds and the power to eliminate problems with difficult venting situations. This significantly quieter motor runs cooler for a considerably longer operational life.
- **Spark-to-Pilot Ignition System**—Eliminates the constant burning pilot used on other water heaters. This device results in savings of pilot gas during standby periods (110 VAC required to heater).
- **Electronic Gas Control Valve**—The integrated, immersion gas control valve offers more precise temperature control for higher first hour delivery and also allows water temperature adjustment without removing the cover. The control is equipped with an LED to display heater status and aid in diagnostics.
- **More Precise Temperature Control**—With an adjustable temperature up to 180° F. Not recommended for 180° F sanitizing.
- **Horizontal and Vertical Venting**—With 3" or 4" PVC, ABS, or CPVC (Maximum equivalent vent length on reverse side).
- **2" Non-CFC Foam Insulation**—Covers the sides and top of tank, reducing the amount of heat loss.
- **Water Connections**—3/4" NPT factory installed true dielectric fittings. Extends water heater life and eases installation.
- **Factory Installed Heat Traps**—Design incorporates a flexible disk that reduces heat loss in piping and eliminates the potential for noise generation.
- **Protective Magnesium Anode Rod**—Provides added protection against corrosion for long trouble-free service.
- **Side Connections**—3/4" NPT female side tapings allow easy connection for space heating applications.
- **T&P Relief Valve**—Installed.
- **Brass Drain Valve.**
- **Design Certified by CSA International (formerly AGA and CGA).**

**3 or 5-Year Limited Tank Warranties / 1-Year Limited Warranty on Component Parts.**

For more information on warranty, please visit [www.bradfordwhite.com](http://www.bradfordwhite.com)

For products installed in USA, Canada and Puerto Rico. Some states do not allow limitations on warranties. See complete copy of the warranty included with the heater.



# Commercial Power Vent Gas Water Heater



## Light Duty TTW®4 Energy Saver Models

NATURAL GAS AND LIQUID PROPANE GAS

Meet or exceed ASHRAE 90.1b (current standard) C.E.C. Listed  
80% Recovery Efficiency

| Model Number    | Capacity  |           | Recovery 100°F Rise* |                  |               |               | A Floor to Vent Conn. in. | B Jacket Dia. in. | C Vent Size in. | D Floor to T&P Conn. in. | E Floor to Gas Conn. in. | F Floor to Space Heating Return in. | G Floor to Space Heating Outlet in. | H Floor to Heater Top in. | J Floor to Water Conn. in. | K Depth in. | Approx. Shipping Weight lbs. |             |             |
|-----------------|-----------|-----------|----------------------|------------------|---------------|---------------|---------------------------|-------------------|-----------------|--------------------------|--------------------------|-------------------------------------|-------------------------------------|---------------------------|----------------------------|-------------|------------------------------|-------------|-------------|
|                 | U.S. Gal. | Imp. Gal. | Nat. BTU/Hr. Input   | LP BTU/Hr. Input | Nat. U.S. GPH | Nat. Imp. GPH |                           |                   |                 |                          |                          |                                     |                                     |                           |                            |             |                              | LP U.S. GPH | LP Imp. GPH |
| TW4-50S-67FB-3N | 48        | 40        | 67,000               | 60,000           | 65            | 54            | 58                        | 49                | 65%             | 22                       | 3                        | 50%                                 | 11%                                 | 13½                       | 50%                        | 56%         | 57%                          | 26%         | 188         |
| TW4-65S-70FB-3N | 65        | 54        | 70,000               | 63,000           | 68            | 57            | 61                        | 51                | 69              | 24                       | 3                        | 53½                                 | 11%                                 | 13½                       | 53%                        | 59%         | 60%                          | 28%         | 222         |
| TW4-75S-76B-3N  | 75        | 62        | 76,000               | 75,500           | 74            | 61            | 73                        | 60                | 69%             | 26                       | 3                        | 53                                  | 15                                  | 17%                       | 53                         | 60%         | 61%                          | 31          | 277         |

| Model Number    | Capacity |          | Recovery 56°C Rise* |             |                  |                | A Floor to Vent Conn. mm. | B Jacket Dia. mm. | C Vent Size mm. | D Floor to T&P Conn. mm. | E Floor to Gas Conn. mm. | F Floor to Space Heating Return mm. | G Floor to Space Heating Outlet mm. | H Floor to Heater Top mm. | J Floor to Water Conn. mm. | K Depth mm. | Approx. Shipping Weight kg. |
|-----------------|----------|----------|---------------------|-------------|------------------|----------------|---------------------------|-------------------|-----------------|--------------------------|--------------------------|-------------------------------------|-------------------------------------|---------------------------|----------------------------|-------------|-----------------------------|
|                 | Liters   | kW Input | Nat. kW Input       | LP kW Input | Nat. Liters/Hour | LP Liters/Hour |                           |                   |                 |                          |                          |                                     |                                     |                           |                            |             |                             |
| TW4-50S-67FB-3N | 182      | 19.6     | 17.6                | 246         | 220              | 1673           | 560                       | 76                | 1273            | 320                      | 343                      | 1273                                | 1432                                | 1467                      | 679                        | 85          |                             |
| TW4-65S-70FB-3N | 246      | 20.5     | 18.5                | 257         | 231              | 1753           | 610                       | 76                | 1360            | 320                      | 343                      | 1360                                | 1511                                | 1543                      | 730                        | 101         |                             |
| TW4-75S-76B-3N  | 284      | 22.3     | 22.1                | 280         | 276              | 1772           | 660                       | 76                | 1346            | 381                      | 451                      | 1346                                | 1530                                | 1562                      | 787                        | 126         |                             |

Propane models feature a Titanium Stainless Steel propane burner. For Propane (LP) models change suffix "B" to "S" and "N" to "X". TW4-75S features a Cast Iron burner. For Propane (LP) model change suffix "B" to "C" and "N" to "X".

For 5 year models, change suffix from "3" to "5".

\*Based on manufacturers rated recovery efficiency.

110 V.A.C. Required for Power Venting / 110 V.A.C. 60HZ 3.1 Amperes.

NSF construction available.

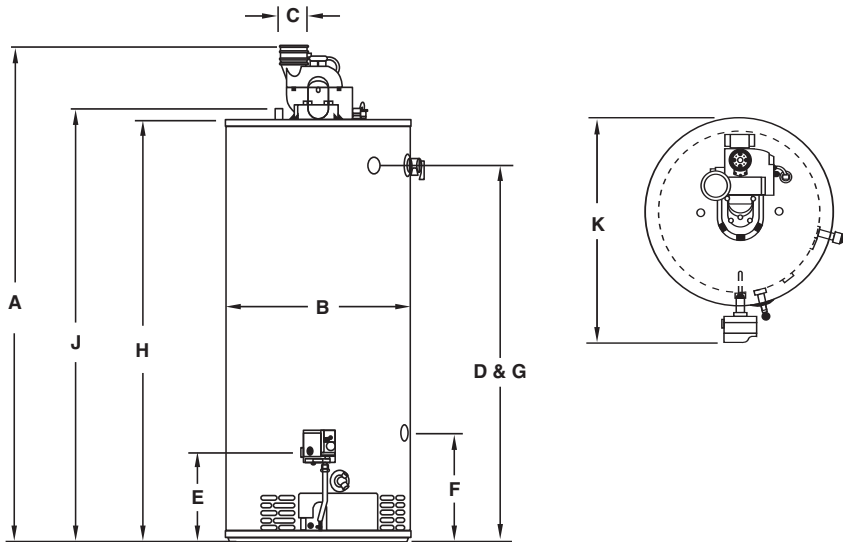

|                        | TW4-50S-67<br>TW4-65S-70<br>TW4-75S-76 | 3" Vent Pipe | 4" Vent Pipe |
|------------------------|--|--------------|--------------|
| Max. Equivalent Length |  | †60 ft.**    | †180 ft.     |
| Min. Equivalent Length |  | 7 ft.        | 15 ft.       |
| Number of 90° Elbows   | 1                                      | 55 ft.       | 175 ft.      |
|                        | 2                                      | 50 ft.       | 170 ft.      |
|                        | 3                                      | 45 ft.       | 165 ft.      |

Subtract 5ft. for each additional 90° elbow  
†For high altitude installations, consult the installation instructions.

\*\*TW4-75S Max. 3" vent length is 50ft.

Note: (TW4-75S will not have a pedestal base).

### Meets NAECA Requirements.

#### General

All gas water heaters are certified at 300 PSI (2068 kPa) test pressure and 150 PSI (1034 kPa) working pressure.

All water connections are 3/4" NPT (19mm) on 11" (279mm) centers, all gas connections are 1/2" (13mm).

All models design certified by CSA International (formerly AGA/CGA), ANSI Z-21.10.1 and/or 10.3 and peak performance rated.

**Dimensions and specifications subject to change without notice in accordance with our policy of continuous product improvement.**

#### Suitable for Water (Potable) Heating and Space Heating

Toxic chemicals, such as those used for boiler treatment, shall NEVER be introduced into this system. This unit may NEVER be connected to any existing heating system or component(s) previously used with a non-potable water heating appliance.



For U.S. and Canada field service, contact your professional installer or local Bradford White sales representative.

Sales 800-523-2931 • Fax 215-641-1670 / Technical Support 800-334-3393 • Fax 269-795-1089 • Warranty 800-531-2111 • Fax 269-795-1089

International: Telephone 215-641-9400 • Telefax 215-641-9750 / www.bradfordwhite.com

**BRADFORD WHITE-CANADA** INC. Sales / Technical Support 866-690-0961 / 905-238-0100 • Fax 905-238-0105 / www.bradfordwhite.com

## Built to be the Best™

©2009, Bradford White Corporation. All rights reserved.